



Quick Reference Notes – **DAILY CARE**

簡易操作 - **日常保養**

Revoria Press SC285S / SC285

CONTENTS

目錄

| | | |
|-----|---|---|
| 1 | Clear Paper Jam 夾紙排解..... | 1 |
| 1.1 | Duplex Automatic Document Feeder / 自動雙面送稿裝置 | 1 |
| 1.2 | Inside Lower Left Cover 左下蓋內部 | 3 |
| 1.3 | Right Side 右側面部..... | 3 |
| 2 | Trays 紙盤..... | 4 |
| 2.1 | Paper Trays 1, 2 & 3 紙盤 1, 2 & 3 | 4 |
| 2.2 | Bypass Tray (Tray 5) 手送紙盤 (紙盤 5)..... | 5 |
| 3 | Transfer Units 轉印元件 | 6 |
| 4 | Replacing Toner 更換碳粉匣..... | 9 |
| 4.1 | Confirm the status of supplies 確認耗材狀態 | 9 |

Scan QR Code OR click here: [Manuals](#) or [Self Help](#).
請掃描二維碼，或點擊：[使用說明](#) 或 [自助式故障排除](#)。

For more online support information please visit:
更多相關資料，請訪問以下網址：
<https://support-fb.fujifilm.com>



Manuals
使用說明



Self Help
自助式故障排除

1 CLEAR PAPER JAM 夾紙排解

1.1 DUPLEX AUTOMATIC DOCUMENT FEEDER / 自動雙面送稿裝置

1. Pull up the front handle of the cover and open the cover until it stops.

1. 提起護蓋前的把手，開啟護蓋直到停止位置。

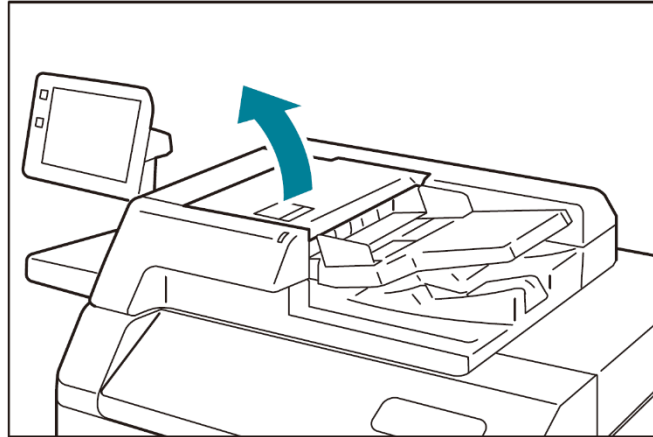

2. Remove the document.

2. 清除原稿。

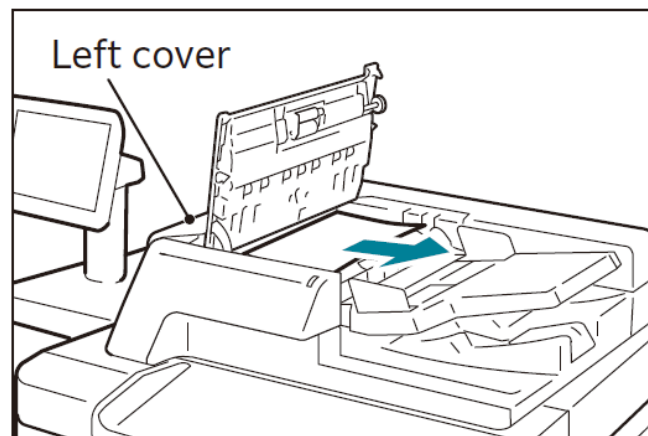

3. If the document is caught in the entry, remove the jammed paper from the Left Cover.

3. 原稿夾在吸入部時，可從左側蓋子進去清除原稿。

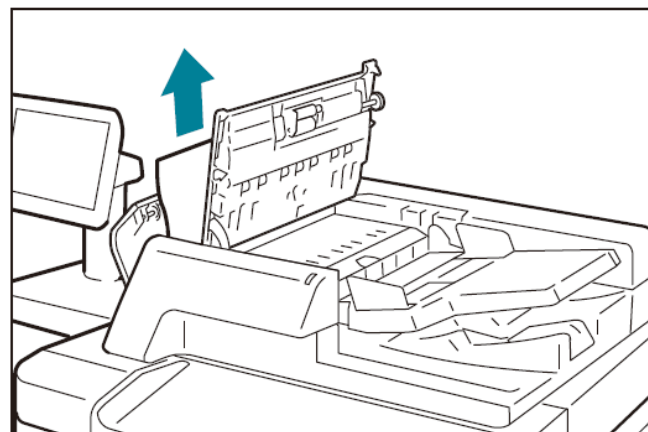

4. If the document is caught in the exit area, lift the Document Feeder Tray and pull the document toward the exit.
4. 輸出口有原稿時，請提起送稿台，朝輸出方向拉取出來。

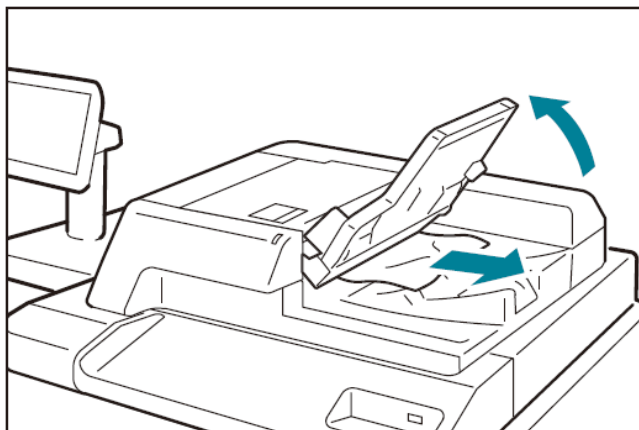

5. Open the Document Cover, pull down the handle to open the Side 2 scanner, and then remove the document.
5. 打開原稿蓋，拉下拉桿，開啟反面掃描部，取出原稿。

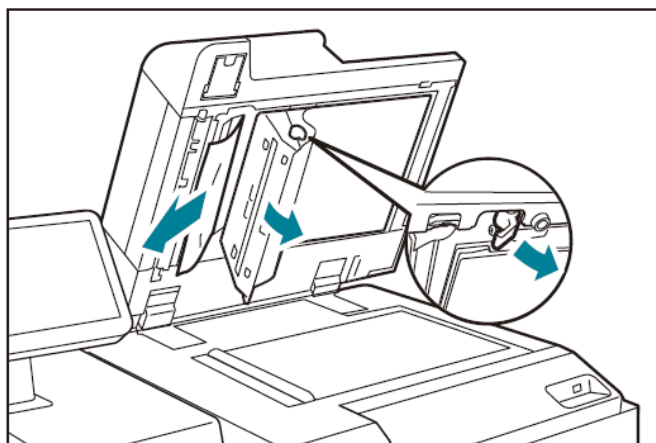

1.2 INSIDE LOWER LEFT COVER 左下蓋內部

1. Open the Lower Left Cover.
2. Remove the jammed paper.

1. 打開左下蓋。
2. 清除卡住的紙張。

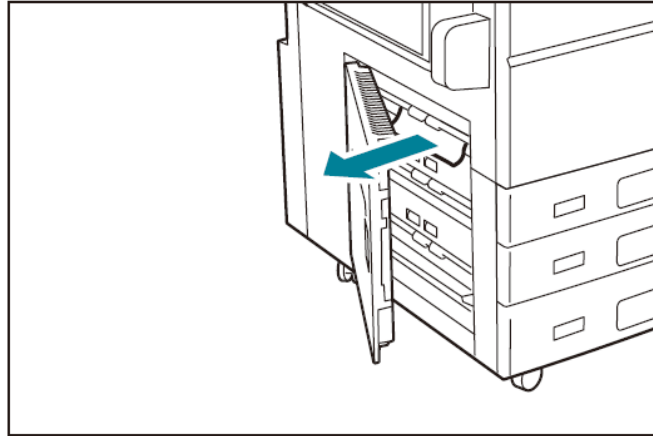

1.3 RIGHT SIDE 右側面部

1. Open the Lower Right Cover.
2. Remove the jammed paper.

1. 打開右下蓋。
2. 清除卡住的紙張。

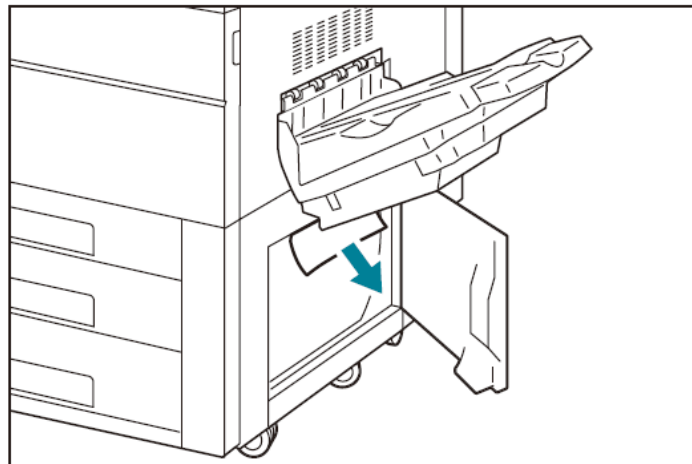

2 TRAYS 紙盤

2.1 PAPER TRAYS 1, 2 & 3 紙盤 1, 2 & 3

1. Pull out the Paper Tray where the paper jam occurred until it stops.

1. 將發生卡紙的紙盤完全拉出。

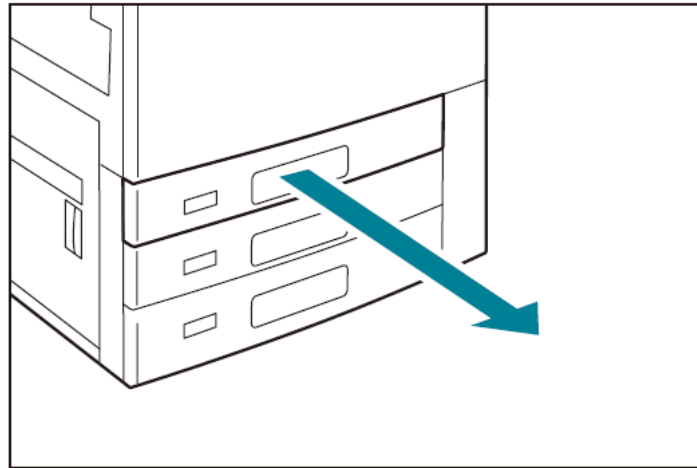

2. Remove the jammed paper.

2. 清除卡住的紙張。

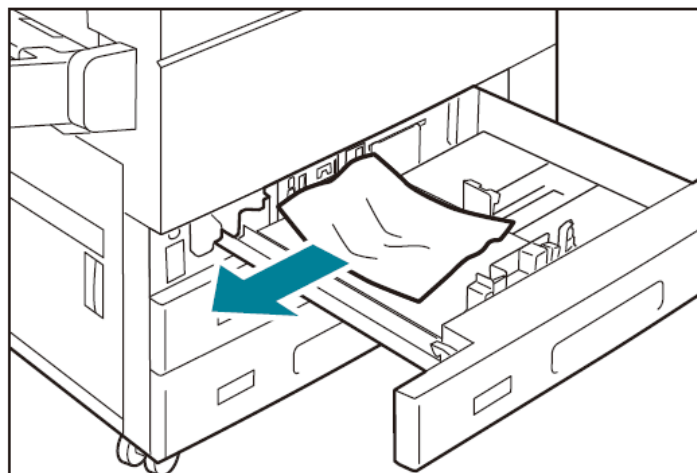

2.2 BYPASS TRAY (TRAY 5) 手送紙盤 (紙盤 5)

1. Remove the jammed paper. When a message appears on the control panel to cut the paper, cut the base of paper without pulling the paper out, and then tap [Confirm].
1. 清除卡住的紙張。如螢幕顯示信息，指示剪去紙張，就剪去紙張底部以上多餘部份，不用拉出紙張。最後按【Confirm】。
2. Remove all the paper from the Paper Tray 5 (Bypass), and then load the paper again. If the paper is not visible, open the Paper Tray 5 (Bypass) Top Cover, and then remove the jammed paper.
2. 移除所有在紙盤 5 (手送紙盤) 的紙張，再重新放置。如看不到卡紙，就打開紙盤五 (手送紙盤) 的上蓋，移除卡紙。

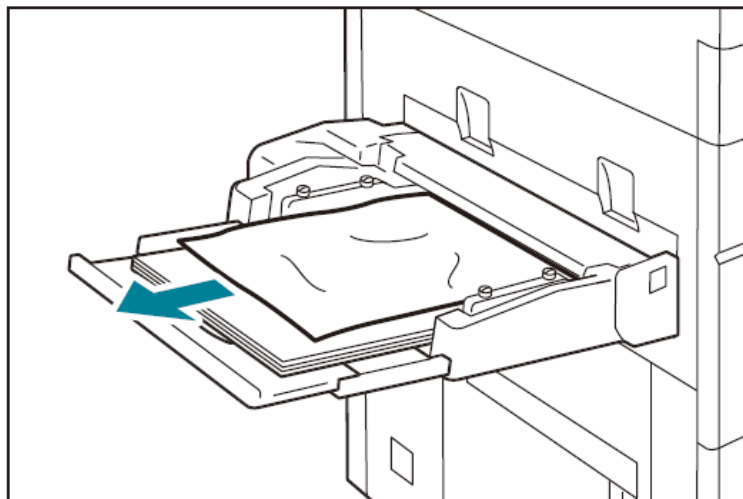

3 TRANSFER UNITS 轉印元件

1. Open the Front Cover.

1. 打開前蓋。

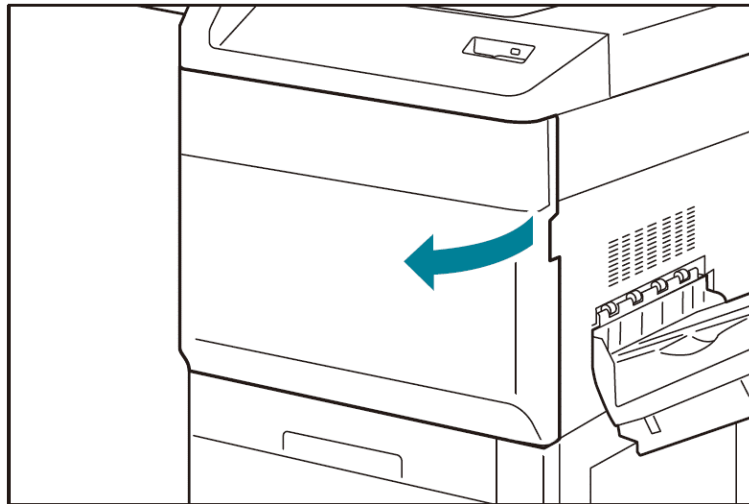

2. Turn the handle [2] of the Transfer Unit to the right until it becomes horizontal (①) and pull the Transfer Unit out to the front until it stops (②).

2. 將轉印元件的拉桿【2】往右旋轉直到呈水平為止(①)，再將轉印元件往前方拉開到停止位置(②)。

3. Slowly pull out the visible paper and remove it.

3. 慢慢拉出可見的卡紙。

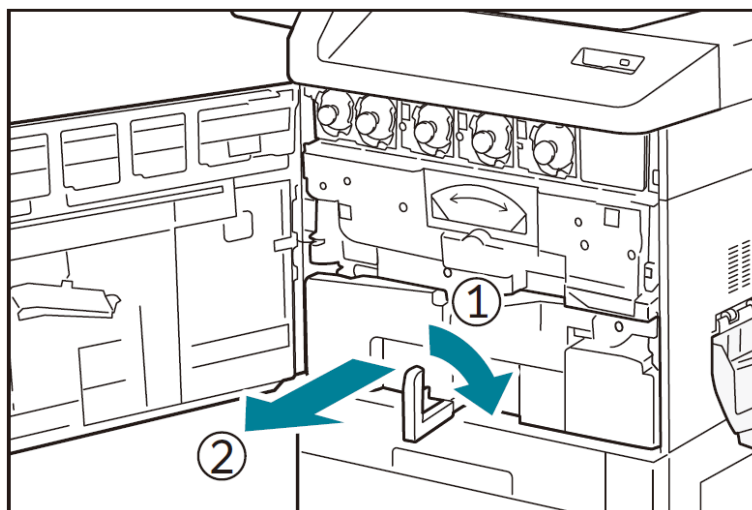

4. Remove the jammed paper at [2a]. Move the handle [2b] to the right and remove the jammed paper. Return the handle [2b].

4. 清除【2a】卡住的紙張。向右拉開【2b】拉桿，清除卡住的紙張。將【2b】拉桿還原。

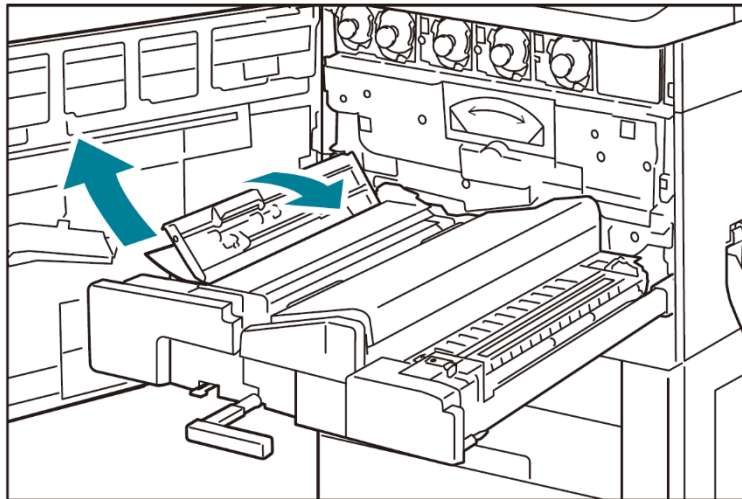

5. Remove the jammed paper at [2c].

5. 清除【2c】卡住的紙張。

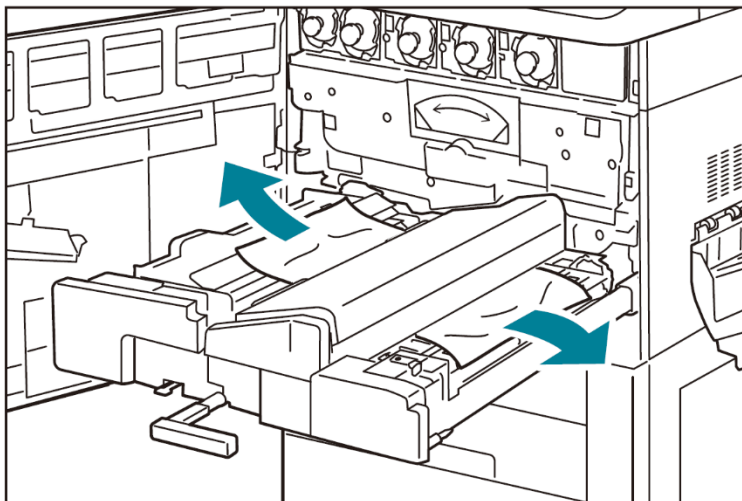

6. Pull up Lever [2d] in order to remove jammed paper. Return Lever [2d].

6. 提起拉桿【2d】，清除卡住的紙張。將【2d】拉桿還原。

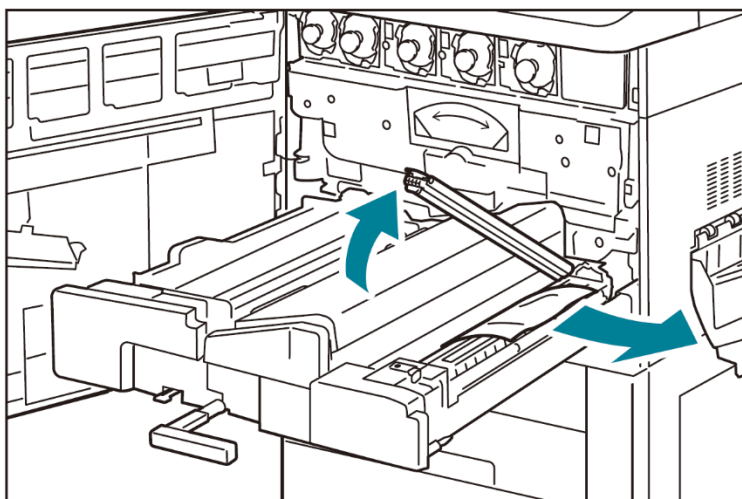

7. Open Lever [2e] to the right and remove jammed paper. Restore Lever [2e].

7. 向右拉開拉桿【2e】，清除卡住的紙張。將【2e】拉桿還原。

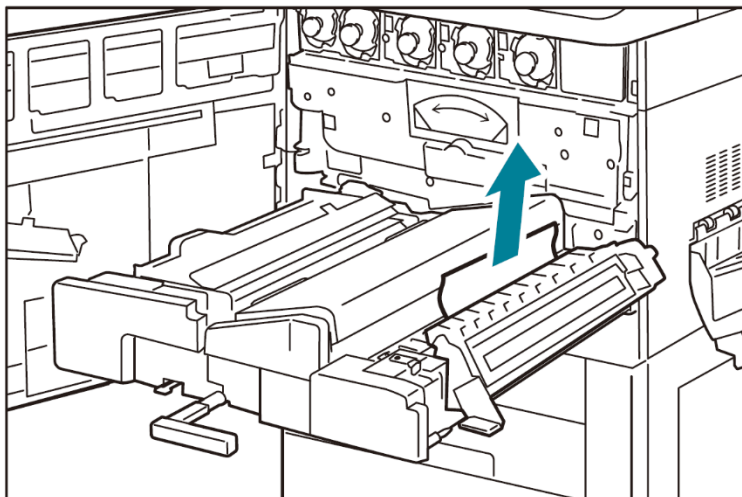

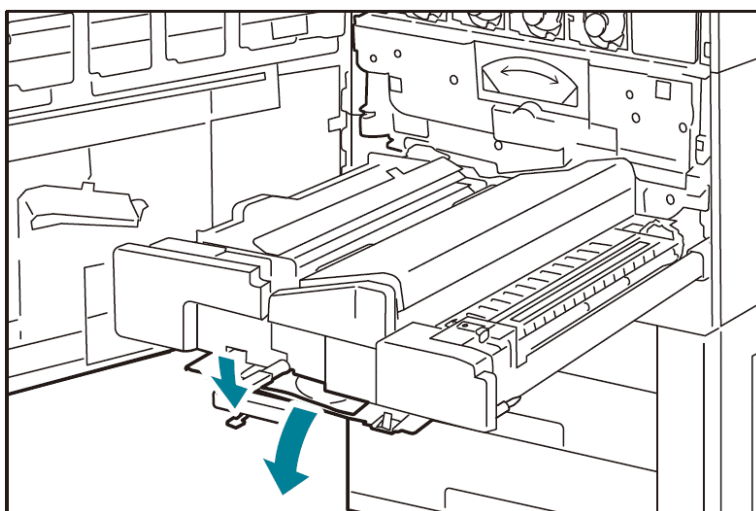

8. Move the handle [2f] down and remove the jammed paper. Return the handle [2f].

8. 拉下拉桿【2f】，清除卡住的紙張。將【2f】拉桿還原。



4 REPLACING TONER 更換碳粉匣

4.1 CONFIRM THE STATUS OF SUPPLIES 確認耗材狀態

1. To display the consumables progress, tap  .
1. 若要顯示各耗材的狀況，請點選  。

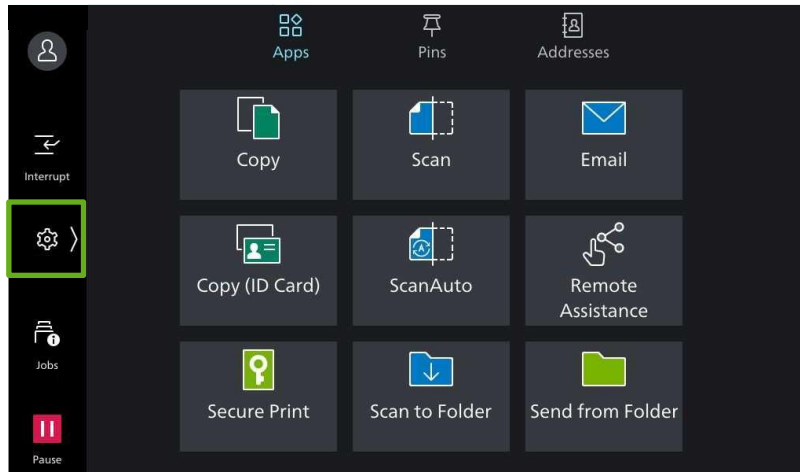

2. Tap [Device Status].
2. 點選【機器確認 (碼錶確認)】。

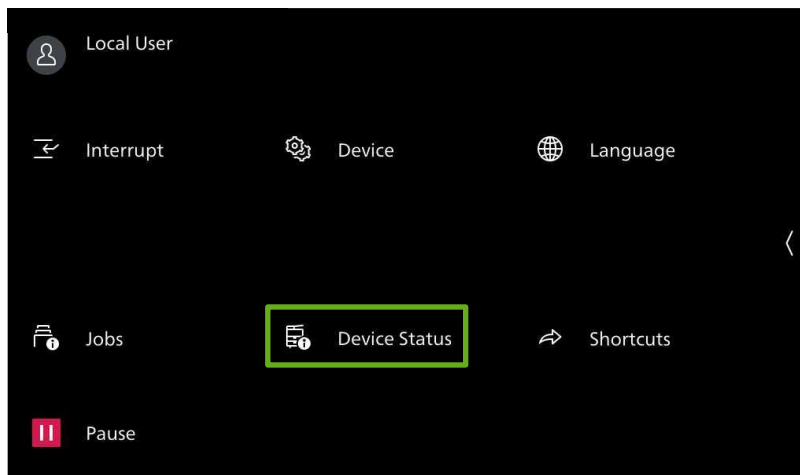

3. Tap [Supplies].
3. 點選【耗材確認】。

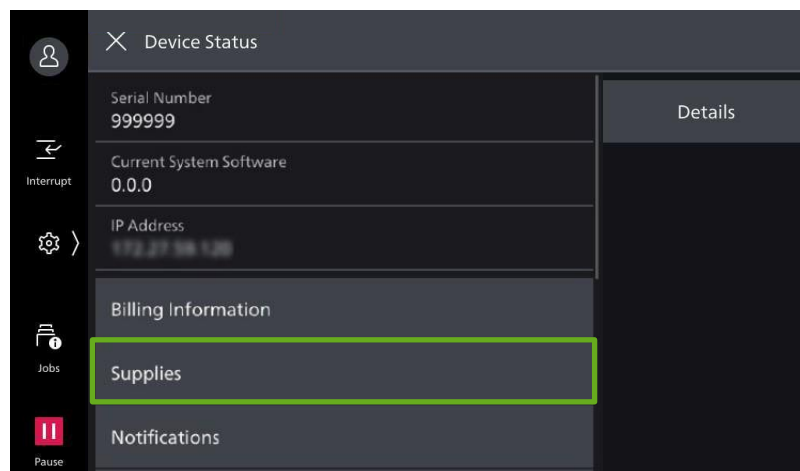

4. For the replacement method, refer to the steps provided on the box of the consumable.

4. 更換的方法請參考耗材外盒上所記載的步驟。

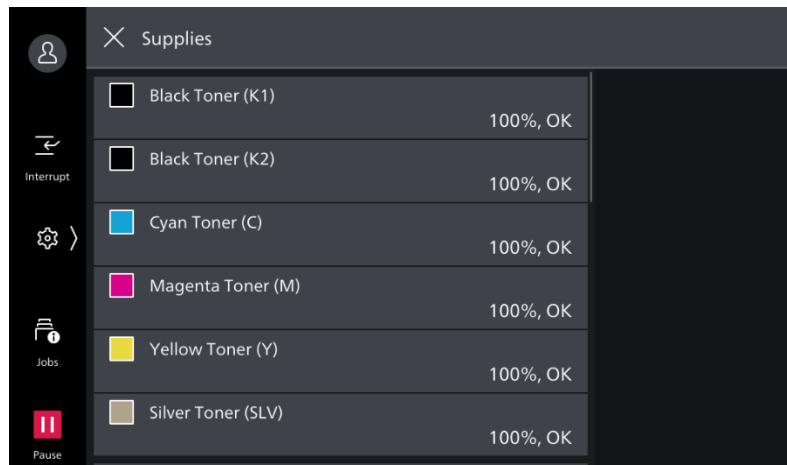

4.2 REMOVE AND INSTALL SPECIALTY TONER 移除和安裝特殊碳粉

Specialty Toner (e.g. Pink) will be removed from the printer when:

- 1) another specialty toner is to be used
- 2) the toner is about to run out

以下情況需要移除特殊碳粉 (如：粉紅)：

- 1) 使用另一款特殊碳粉
- 2) 碳粉快將耗盡

For removal of the existing toner and installation of another toner, please go to this video:

了解如何移除使用中碳粉以及如何安裝另一款碳粉，請到以下連結觀看指導影片：

<https://youtu.be/W2dkM2hQr2A?si=PeFzLs1yrwbc1g8K>

Scan the QR code for viewing on mobile device:

亦可使用手提裝置掃描以下二維碼觀看影片：



Customer Support Center

Telephone

Hong Kong (852) 2513-2513

Macau (853) 2855-8008

Email

shm-fbhc-csc@fujifilm.com

Live Chat

<https://www.fujifilm.com/fbhc/en>

(Find Chat with Us! in the bottom right)