

A4 Monochrome Printer

ApeosPrint 4620 SDW / 4620 SDN

Driving productivity to the next level



 ApeosPrint™



The ApeosPrint 4620 SDW / 4620 SDN machines are robust and compact, a practical solution for busy offices.



ApeosPrint 4620 SDW

ApeosPrint 4620 SDW / 4620 SDN

- A4 Monochrome printer

Product	Print Speed	Printing Resolution	Control Panel	Ethernet	Wi-Fi
ApeosPrint 4620 SDW	Monochrome 46 ppm*	1,200 x 1,200 dpi	1-Line LCD	Gigabit (1000BASE-T)	Standard
ApeosPrint 4620 SDN					-

* A4.

For personal or workgroup users, each of these economical models deliver in convenience, connectivity and capacity

Powerful

- Great functions & performance improve workflow & productivity within an office.
- High speed (46 pages per minute) printing helps get the job done fast.
- Additional paper tray option helps improve productivity for users with high print volume by reducing routine of replenishing paper.
- Large capacity toner units reduces the need for toner replacements.
- Users can select different paper quality and thickness according to their needs.
- Gigabit Ethernet® 1000BASE-T.
- Print Resolution: 1,200 x 1,200 dpi
- Fujifilm Print Utility, AirPrint, and Mopria® Print Service are supported*.

* For ApeosPrint 4620 SDW model.

Convenient

- Compact, sensible and stylish design.
- You select an access method that works for you. Simultaneous connection with Ethernet and Wi-Fi Direct* enables easy connection with the machine.

* For ApeosPrint 4620 SDW model.



Reliable

- Responds to your high-volume printing needs with high durability (Machine life up to 300,000 pages).
- Secure Print function enables you, and only you to print and access your own output on-demand.





Protect your confidential information & reduce security risk

- Limit user access through the utilisation of LDAP or Windows Active Directory.
- Impose restrictions on usage of device functions with Secure Function Lock and Setting Lock.
- Ensure device integrity with runtime intrusion detection, Secure Boot, firmware with digital signatures, and end-to-end encrypted connections.

Two-way (front & back) printing output

- Simply select the output point (front or back output tray) that matches the type of paper to be used.
- The machine adopts a straight paper path, which produces face-up print output. Minimal curling when using thick paper.

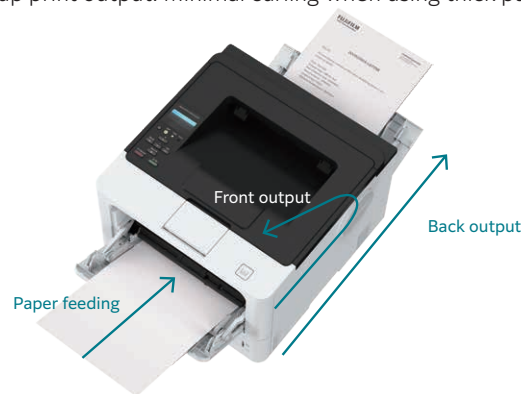

Packed with smart features

- Easy Front Access: Access print output and replace consumables (such as toner and paper) quickly, simply and cleanly from the front of the machine.

- 1. Bypass Tray (100 sheets):** Capable of handling different types & sizes of paper, envelopes, labels, and post cards.
- 2. Standard Tray (250 sheets):** This tray is for standard users. Various types & sizes of paper can be used.
- 3. 520 Sheet Feeder*1:** Even if users want to print high-volume documents, the machine can respond to the needs with a maximum paper feeding capacity 1,390 sheets*2.

Note: Paper feeding capacity is based on 80 gsm paper.

*1: Optional. 250 Sheet Feeder and 520 Sheet Feeder are available. Up to two optional feeders can be added.

*2: When two 520 Sheet Feeders are added.

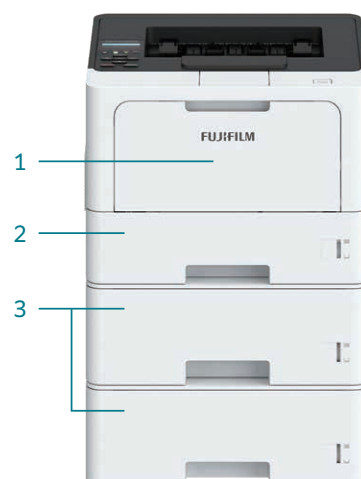

ApeosPrint 4620 SDW / 4620 SDN

Functions & Specifications

Basic Functions & Specifications

Item		ApeosPrint 4620 SDW	ApeosPrint 4620 SDN
Printing Method		Laser electrophotography	
Warm-up Time		25 seconds or less (23 degrees Celsius room temperature). 6 seconds or less from Sleep Mode(23 degrees Celsius room temperature).	
Continuous Print Speed*1	Simplex	46 ppm	
	Duplex	24 ppm	
First Print Output Time*2		6.7 seconds or less(A4)	
Printing Resolution		300 x 300 dpi, 600 x 600 dpi, 2,400 x 600 dpi, 1,200 x 1,200 dpi	
Paper Size	Standard Tray	A4, Letter, JIS B5, A5, A5 LEF, A6, Executive, Legal, Folio (216 x 330 mm)	
	Bypass Tray	A4, Letter, JIS B5, A5, A5 LEF, A6, Executive, Legal, Envelope: COM-10, DL, C5, Monarch, Folio (216 x 330 mm) Custom size (Width: 69.8 to 216 mm, Length: 127 to 355.6 mm)	
	Optional Tray	A4, Letter, JIS B5, A5, Executive, Legal, Folio (216 x 330 mm)	
	2 Sided Printing	A4, Letter, Legal	
Paper Weight*3	Standard Tray	60 to 163 gsm	
	Bypass Tray	60 to 230 gsm	
	Optional Tray	60 to 120 gsm	
	2 Sided Printing	60 to 105 gsm	
Paper Tray Capacity*4	Standard	Standard Tray: 250 sheets Bypass Tray: 100 sheets	
	Optional	250 Sheet Feeder: 250 sheets 520 Sheet Feeder: 520 sheets	
	Max	1,390 sheets [Standard Tray + Bypass Tray + 520 Sheet Feeder x 2]	
	Output Tray Capacity*4	150 sheets (face down), 1 sheet (face up)	
CPU		Cortex-A53 1.2 GHz Dual Core	
Memory Capacity		1 GB (Max: 1 GB)	
Storage Device Capacity		-	
Page Description Language	Standard	PCL6, PostScript language compatibility	
	Supported Operating System*5	Windows 11 (64 bit), Windows 10 (32 bit / 64 bit), Windows Server 2022 (64 bit), Windows Server 2019 (64 bit), Windows Server 2016 (64 bit) macOS 14 / 13 / 12	
Interface	Standard	Ethernet 1000BASE-T / 100BASE-TX / 10BASE-T USB Hi-Speed 2.0	
	Wireless LAN (IEEE802.11b/g/n) -	-	
Network Protocol		TCP/IP (Ipd, IPP / IPPS, Port9100)	
Power Supply*6		AC220-240 V +/- 10 %, 10 A, 50/60 Hz common	
Operating Noise*7*8	In Operation:	7.2 B, 54 dB (A)	
	Ready Mode:	5.3 B, 35 dB (A)	
Maximum Power Consumption	Max	1,280 W	
	Average	Ready Mode: 31 W In Operation: 670 W Sleep Mode: 0.5 W	
	Dimensions	W 373 x D 388 x H 257 mm	
	Weight	10.8 kg (Including consumables and drum) 9.5 kg (Excluding consumables and drum)	

Note: Custom Paper Size setting may be required depending on the paper size.

*1: When Continuously Printing Original in A4 (Plain). The performance may be reduced depending on the paper type and the paper size. The speed may be reduced due to the temperature conditions.

*2: When feeding from feeder tray of machine. Numeric value varies depending on output environment.

*3: It is recommended to use our recommended paper. Correct print output may not be possible depending on the requirement.

*4: 80 gsm paper.

*5: Please refer to our official website for the latest supported OS.

*6: Power outlets that provide the above power level is recommended. Maximum machine measured current: 5.3 A.

*7: Measured in accordance to ISO7779. Unit B: Sound Power Level L_{WAd} . Unit dB: Radiated Sound Pressure Level L_{pAm} (bystander position), as reference value.

*8: Main unit only.

250 Sheet Feeder (Optional)

Item	Description
Paper Size	Max: A4, Letter, Legal
	Min: A5
Paper Weight	60 to 120 gsm
Feeding Capacity / Number of Tray*	250 sheets x 2 Tray
Dimensions	W 363 x D 384 x H 122 mm
Weight	2.8 kg

* 80 gsm paper.

520 Sheet Feeder (Optional)

Item	Description
Paper Size	Max: A4, Letter, Legal
	Min: A5
Paper Weight	60 to 120 gsm
Feeding Capacity / Number of Tray*	520 sheets x 2 Tray
Dimensions	W 363 x D 384 x H 152 mm
Weight	3.9 kg

* 80 gsm paper.

Consumables

Product Name	Product Code	Product Life
Toner Cartridge (Starter)	-	Up to 3,000 pages*1
Toner Cartridge Standard Capacity	CT204229	Up to 6,000 pages*1
Toner Cartridge Ultra High Capacity	CT204231	Up to 18,000 pages*1
Drum Cartridge	CT351436	Up to 73,000 pages*2

*1: Published value based on ISO/IEC 19752 standards. The actual number of printable pages may vary significantly from the published value, depending on printing content, paper size, paper type, usage conditions, and other such usage environment conditions.

*2: Approximately 45,000 pages based on 1 page per job and 73,000 pages based on 3 pages per job. The number of pages may be affected due to a variety of factors including but not limited to media type and media size.

Notes

- 1) To comply with paper weight specifications, it is recommended to use our recommended paper. Document may not be printed correctly depending on usage conditions.
- 2) Functional spare parts will be available for at least 7 years after the product is no longer manufactured.

FUJIFILM

FUJIFILM Business Innovation Vietnam Co., Ltd.

Head Office

Ground Floor, 2nd Floor and 19th Floor, The Hallmark Building, 15 Tran Bach Dang, Thu Thiem Ward, Thu Duc Dist, Hochiminh City
Tel: (84-28) 38 290 038 Fax: (84-28) 38 290 032

Ha Noi Branch

14th Floor, VCCI Tower 9 Dao Duy Anh, Dong Da Dist., Ha Noi
Tel: (84-24) 38 241 063 Fax: (84-24) 38 241 113

Hai Phong Branch

5th Floor, TD Office Building 20A Le Hong Phong, Ngo Quyen Dist., Hai Phong
Tel: (84-225) 3859 236 Fax: (84-225) 3859 239

Da Nang Branch

3rd Floor, Danabook Building 76-78 Bach Dang, Hai Chau Dist., Danang
Tel: (84-236) 3892 896 Fax: (84-236) 3892 895

fujifilm.com/fbvn

The available model varies depending on the country/region. Please ask the sales representatives for details.

The product specifications, appearance and other details in this brochure are subject to change without notice for improvements.

Reproduction Prohibitions Please note that reproduction of the following is prohibited by law : •Domestic and foreign currencies, government-issued securities, and national bonds and local bond certificates. •Unused postage stamps, post cards, etc. •Certificate stamps stipulated by law. •Reproducing works forming the subject matter of copyright (literary works, musical works, paintings, engravings, maps, cinematographic works, drawings, photographic works, etc.) is not permitted unless the reproduction is for the purpose of personal use, family use or other similar uses within a limited circle.

Trademarks •FUJIFILM and FUJIFILM logo are registered trademarks or trademarks of FUJIFILM Corporation.

•ApeosPrint is registered trademarks or trademarks of FUJIFILM Business Innovation Corp.
•Microsoft, Active Directory, Azure, Microsoft Entra, Microsoft Edge, Excel, OneDrive, PowerPoint, SharePoint, Microsoft Teams, Windows, and Windows Server are registered trademarks of US Microsoft Corporation in the U.S. and other countries. •Apple, Mac, macOS, OS X, AirPrint, and AirPrint logo are trademarks of Apple Inc. registered in the U.S. and other countries and regions. •Mopria, the Mopria Logo, and the Mopria Alliance word mark and logo are registered and/or unregistered trademarks and service marks of Mopria Alliance, Inc. in the United States and other countries. •All product names and company names mentioned in this brochure are trademarks or registered trademarks of their respective companies.



For Your Safety

Before using the product, read the Instruction Manual carefully for proper use. Use the product with the power source and voltage specified. Be sure to establish ground connection. Otherwise, electronic shock may result in the case of a failure or short circuit.

The information is as of September, 2024 PIC-0238 VN (2409)